

MODEL 8092 EXPLOSION PROOF INSTRUMENT ENCLOSURE

- EXPLOSION PROOF CERTIFIED
- NEMA 4X OR IP66/67 CONSTRUCTION
- CHOICE OF SS316 AND COPPER-FREE ALUMINUM
- CHOICE OF TEMPERED GLASS COVER OR BLIND COVER
- WIDE SELECTION OF CONDUIT SIZES
- WIDE RANGE OF ACCESSORIES



Introduction

Material of Construction:

Copper-Free Aluminum or SS316

Certification:

FM / ATEX / IECEx Explosion Proof Certified

Connections

1/2" NPT, 3/4" NPT, 1/2" NPSM, 3/4" NPSM, M20x1.5

Mounting Holes

As per requirement

Surface Finishing

Epoxy Coated for Aluminum; Electro Polish for SS316

"O" Ring

Buna "N"

Weight

2.01Kg (4.4lbs) for Aluminum; 2.65Kg (5.8lbs) for SS316

Accessories

[Click to View IME Explosion Proof Plugs](#)

Certification System

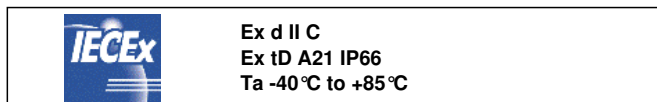
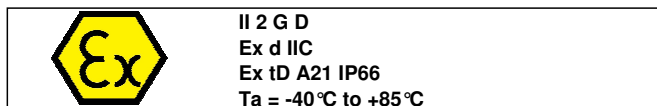
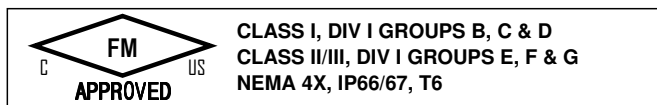

Dimensions (based on Aluminum Version)

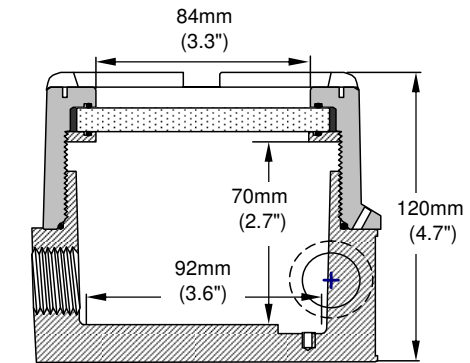

CROSS SECTION WITH GLASS COVER

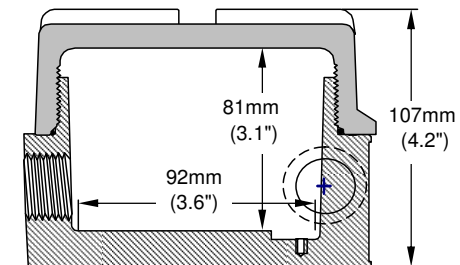

CROSS SECTION WITH BLIND COVER

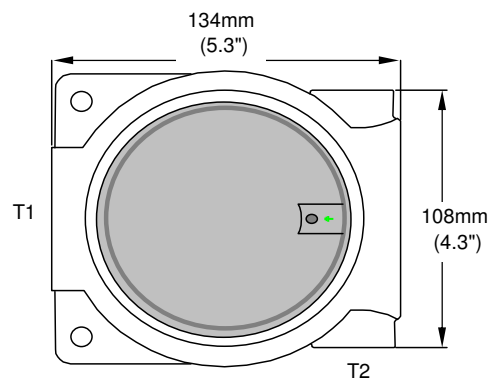

TOP VIEW OF HOUSING

MODEL 8092 EXPLOSION PROOF INSTRUMENT ENCLOSURE

IME Model 8092 Series Instrument Enclosures are designed to accommodate circuit boards and devices having a maximum diameter of 92mm(3.6") Specifically designed for explosion proof applications, the housing is available in either an epoxy painted Copper-Free Aluminum version or investment casted SS316 to withstand applications where aggressive atmospheres prevail. The housing can be ordered with either a tempered glass cover or blind cover. There is a wide choice of conduit and instrument entries.

Ordering Information

Model	Description																																																						
8092AN	General Purpose, Die Cast Aluminum, 3 Ports Instrument Enclosure With Blind Cover																																																						
8092AE	FM (US & Canada) Explosion Proof Certified, NEMA 4X, Die Cast Aluminum, 3 Ports Instrument Enclosure With Blind Cover																																																						
8092AT	ATEX/IECEX Explosion Proof Certified, IP68, Die Cast Aluminum, 3 Ports Instrument Enclosure With Blind Cover																																																						
8092AM	FM (US & Canada)/ATEX/IECEX Explosion Proof Certified, NEMA 4X, IP68, Die Cast Aluminum, 3 Ports Instrument Enclosure With Blind Cover																																																						
8092WN	General Purpose, Die Cast Aluminum, 3 Ports Instrument Enclosure With Tempered Glass Window																																																						
8092WE	FM (US & Canada) Explosion Proof Certified, NEMA 4X, Die Cast Aluminum, 3 Ports Instrument Enclosure With Tempered Glass Window																																																						
8092WT	ATEX/IECEX Explosion Proof Certified, IP68, Die Cast Aluminum, 3 Ports Instrument Enclosure With Tempered Glass Window																																																						
8092WM	FM (US & Canada)/ATEX/IECEX Explosion Proof Certified, NEMA 4X, IP68, Die Cast Aluminum, 3 Ports Instrument Enclosure With Tempered Glass Window																																																						
8092TN	General Purpose, SS316 Housing, 3 Ports Instrument Enclosure With Blind Cover																																																						
8092TE	FM (US & Canada) Explosion Proof Certified, NEMA 4X, SS316 Housing, 3 Ports Instrument Enclosure With Blind Cover																																																						
8092TT	ATEX/IECEX Explosion Proof Certified, IP68, SS316 Housing, 3 Ports Instrument Enclosure With Blind Cover																																																						
8092TM	FM (US & Canada)/ATEX/IECEX Explosion Proof Certified, NEMA 4X, IP68, SS316 Housing, 3 Ports Instrument Enclosure With Blind Cover																																																						
8092SN	General Purpose, SS316 Housing, 3 Ports Instrument Enclosure With Tempered Glass Window																																																						
8092SE	FM (US & Canada) Explosion Proof Certified, NEMA 4X, SS316 Housing, 3 Ports Instrument Enclosure With Tempered Glass Window																																																						
8092ST	ATEX/IECEX Explosion Proof Certified, IP68, SS316 Housing, 3 Ports Instrument Enclosure With Tempered Glass Window																																																						
8092SM	FM (US & Canada)/ATEX/IECEX Explosion Proof Certified, NEMA 4X, IP68, SS316 Housing, 3 Ports Instrument Enclosure With Tempered Glass Window																																																						
	<table border="1"> <thead> <tr> <th>Code</th> <th>T1</th> <th>T2</th> </tr> </thead> <tbody> <tr> <td>04</td> <td>1/2"NPT</td> <td>3/4"NPT</td> </tr> <tr> <td>05</td> <td>1/2"NPT</td> <td>1/2"NPT</td> </tr> <tr> <td>06</td> <td>1/2"NPT</td> <td>M20 x 1.5P (See Note 1)</td> </tr> <tr> <td>07</td> <td>3/4"NPT</td> <td>3/4"NPT</td> </tr> <tr> <td>08</td> <td>3/4"NPT</td> <td>1/2"NPT</td> </tr> <tr> <td>09</td> <td>3/4"NPT</td> <td>M20 x 1.5P (See Note 1)</td> </tr> <tr> <td>10</td> <td>1/2"BSP (See Note 2)</td> <td>3/4"NPT</td> </tr> <tr> <td>11</td> <td>1/2"BSP (See Note 2)</td> <td>1/2"NPT</td> </tr> <tr> <td>12</td> <td>1/2"BSP (See Note 2)</td> <td>M20 x 1.5P (See Note 1)</td> </tr> <tr> <td>13</td> <td>3/4"NPT</td> <td>None</td> </tr> <tr> <td>14</td> <td>M20 x 1.5P (See Note 1)</td> <td>None</td> </tr> <tr> <td>16</td> <td>1/2"BSP (See Note 2)</td> <td>None</td> </tr> <tr> <td>17</td> <td>1/2"NPT</td> <td>None</td> </tr> <tr> <td>18</td> <td>None</td> <td>None</td> </tr> <tr> <td>19</td> <td>None</td> <td>3/4"NPT</td> </tr> <tr> <td>20</td> <td>None</td> <td>1/2"NPT</td> </tr> <tr> <td>21</td> <td>None</td> <td>M20 x 1.5P (See Note 1)</td> </tr> </tbody> </table>	Code	T1	T2	04	1/2"NPT	3/4"NPT	05	1/2"NPT	1/2"NPT	06	1/2"NPT	M20 x 1.5P (See Note 1)	07	3/4"NPT	3/4"NPT	08	3/4"NPT	1/2"NPT	09	3/4"NPT	M20 x 1.5P (See Note 1)	10	1/2"BSP (See Note 2)	3/4"NPT	11	1/2"BSP (See Note 2)	1/2"NPT	12	1/2"BSP (See Note 2)	M20 x 1.5P (See Note 1)	13	3/4"NPT	None	14	M20 x 1.5P (See Note 1)	None	16	1/2"BSP (See Note 2)	None	17	1/2"NPT	None	18	None	None	19	None	3/4"NPT	20	None	1/2"NPT	21	None	M20 x 1.5P (See Note 1)
Code	T1	T2																																																					
04	1/2"NPT	3/4"NPT																																																					
05	1/2"NPT	1/2"NPT																																																					
06	1/2"NPT	M20 x 1.5P (See Note 1)																																																					
07	3/4"NPT	3/4"NPT																																																					
08	3/4"NPT	1/2"NPT																																																					
09	3/4"NPT	M20 x 1.5P (See Note 1)																																																					
10	1/2"BSP (See Note 2)	3/4"NPT																																																					
11	1/2"BSP (See Note 2)	1/2"NPT																																																					
12	1/2"BSP (See Note 2)	M20 x 1.5P (See Note 1)																																																					
13	3/4"NPT	None																																																					
14	M20 x 1.5P (See Note 1)	None																																																					
16	1/2"BSP (See Note 2)	None																																																					
17	1/2"NPT	None																																																					
18	None	None																																																					
19	None	3/4"NPT																																																					
20	None	1/2"NPT																																																					
21	None	M20 x 1.5P (See Note 1)																																																					
8092SE	08 ← Typical Model Number																																																						

Note:

1. A temporary metric label is required when an M20 x 1.5P thread is selected. However this thread option is not allowed in Canada.
2. 1/2"BSP thread is not FM Approved.